

WYMIARY MONTAŻOWE I ZEWNĘTRZNE DO KARTY:

Ta-41.2000; Ta-58.2000; Ta-65.2000

THE MOUNTING AND OVERALL DIMENSION CONC. THE CATALOGUE CARD NO:

Ta-41.2000; Ta-58.2000; Ta-65.2000

DIE ANBAU-UND AUSSENMASSE ZUR KARTE:

Ta-41.2000; Ta-58.2000; Ta-65.2000

WYMIARY MONTAŻOWE I ZEWNĘTRZNE SILNIKI NA ŁAPACH

PRINCIPAL DIMENSIONS FOOT - MOUNTED MOTORS

ABMESSUNGEN MOTOREN IN FUSSAUSFÜHRUNG

Formy wykonania: IMB3, IMB6, IMB7, IMB8, IMV5,
Types of construction: IMV6 - DIN 42950, IEC 34-7
Bauformen:

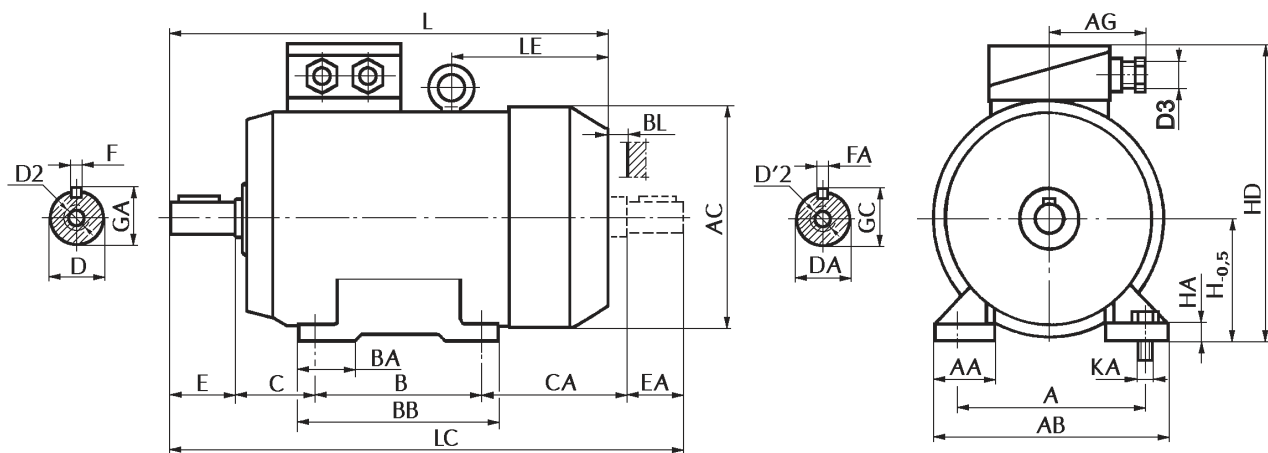

IMB3

Typ Frame size Typ	Wymiary montażowe [mm] Mounting dimensions [mm] Einbaumasse [mm]														Wymiary zewnętrzne [mm] Overall dimensions [mm] Ausßenmasse [mm]										Łożysko Bearing Kugellager						
	A	B	BL	C	CA	D	DA	D2	D'2	E	EA	F	FA	GA	GC	H	KA	D3	L	LC	AA	AB	AC	AG		BA	BB	HA	HD	LE	
Sg63	100	80	12	40	-	11j6	11j6	M4	M4	23	23	4h9	4h9	12,5	12,5	63	M6	M20	207	-	19	119	126	65	30	100	2	163	-	6202 ZZ	
Sg71	112	90	12	45	81	14j6	14j6	M5	M5	30	30	5h9	5h9	16	16	71	M6	M20	240	276	27	136	143	58	25	108	9	180	-	6203 ZZ	
Sg80	125	100	15	50	90	19j6	19j6	M6	M6	40	40	6h9	6h9	21,5	21,5	80	M8	M20	280	320	30	155	163	58	27	125	9	198	-	6204 ZZ	
Sg90S	140	100	15	56	111	24j6	24j6	M8	M8	50	50	8h9	8h9	27	27	90	M8	M20	306	367	45	170	180	91	38	126	10	232	-	6205 ZZ	
Sg90L		125																							43	151					15*
Sg100L	160	140	15	63	126	28j6	28j6	M10	M10	60	60	8h9	8h9	31	31	100	M10	M20	374	449	32	188	206	91	40	170	4	255	133	6206 ZZ	
Sg112M	190	140	30	70	124	28j6	28j6	M10	M10	60	60	8h9	8h9	31	31	112	M10	M25	383	454	33	220	233	93	40	170	4	280	135	6306 ZZ	
Sg132S	216	140	30	89	143	38k6	38k6	M12	M12	80	80	10h9	10h9	41	41	132	M10	M25	440	532	35	244	263	93	71	210	5	313	138	6308 ZZ	
Sg132S-2B					183																				210	18*					178
Sg132M					145																				210	18*					192*
Sg160M	254	210	5	108	-	42k6	42k6	M16	M16	110	110	12h9	12h9	45	45	160	M14	M32	605	720	49	304	314	-	-	304	5	400	-	6309 ZZ	
Sg160L		254			177*	38k6*	38k6*												112*	80*											10h9*
Sg180M	279	241	5	121	-	48k6	48k6	M16	M16	110	110	14h9	14h9	51,5	51,5	180	M14	M32	667	782	50	329	358	-	-	329	6	440	-	6310 ZZ	
Sg180L		279			185*	38k6*	38k6*												112*	80*											10h9*
																															6309 ZZ
																															6311 ZZ
																															6309 ZZ

* Obudowa żeliwna

* Frame of grey cast iron

* Gehäuse aus Grauguss